

Premium ERGOLab Mobile Workbenches

SAVE \$1600
IN-STOCK
ONLY 2 AVAILABLE

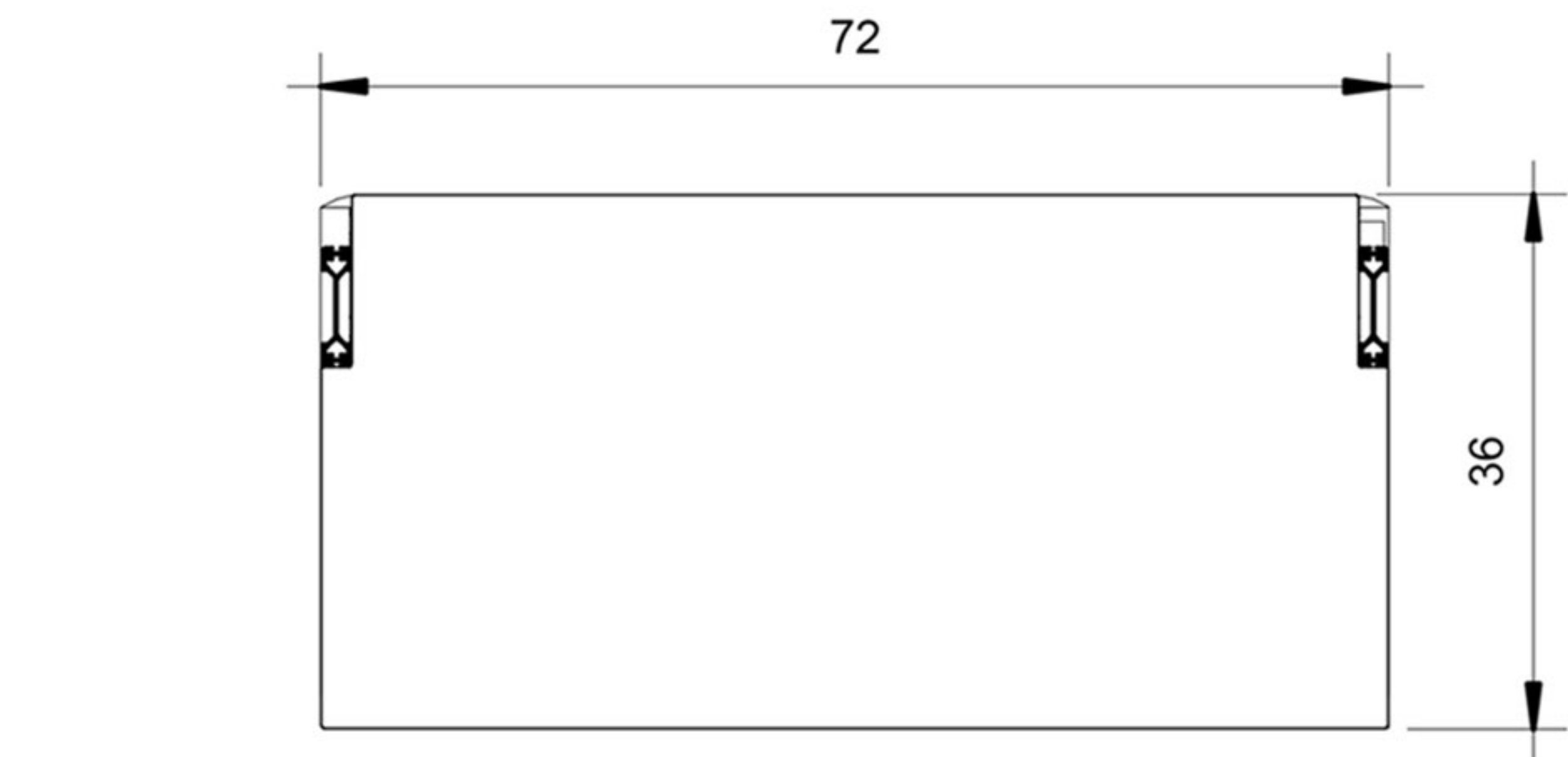

1 BENCH TOP VIEW
2.0/2.0 1/2" = 1'-0"

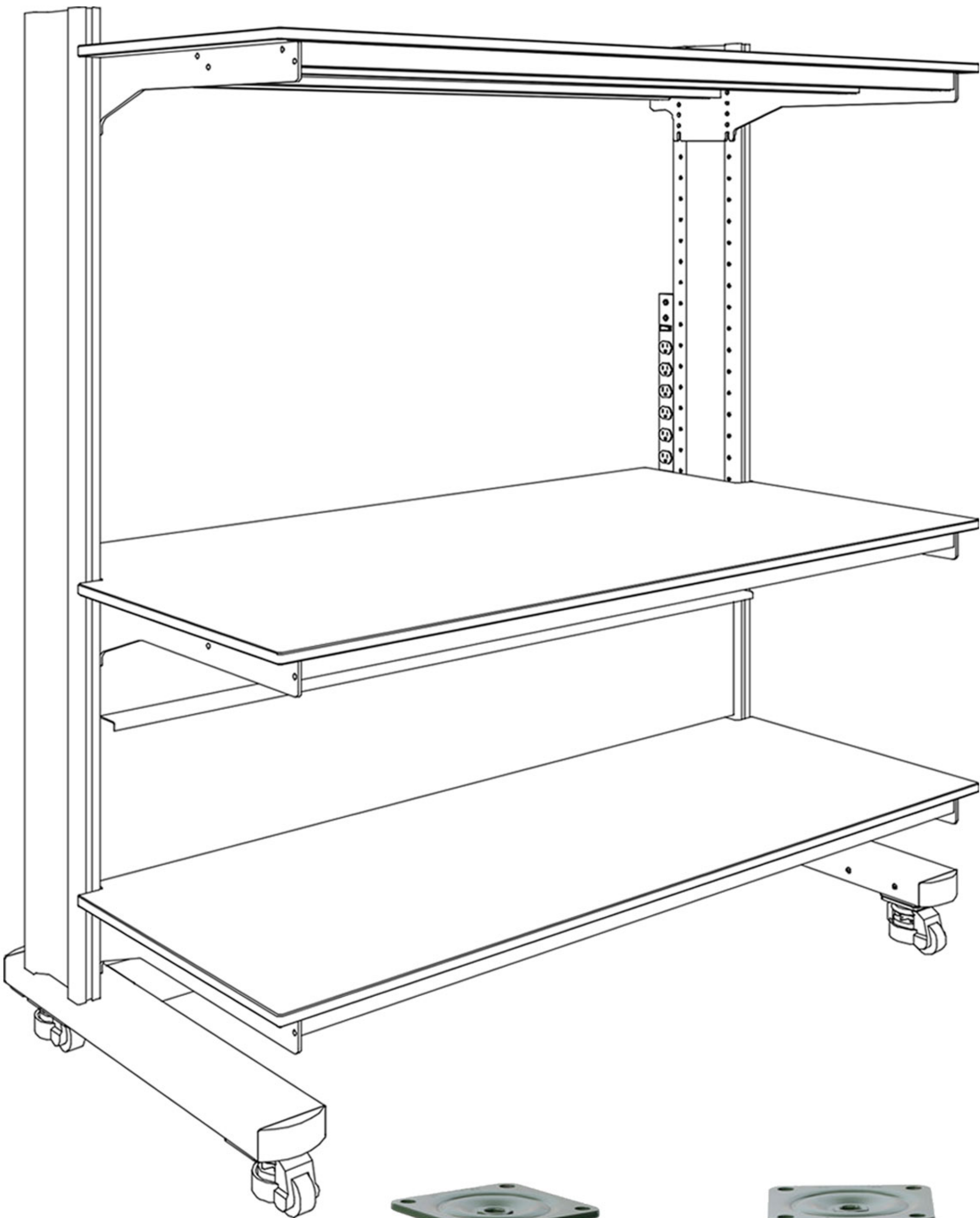
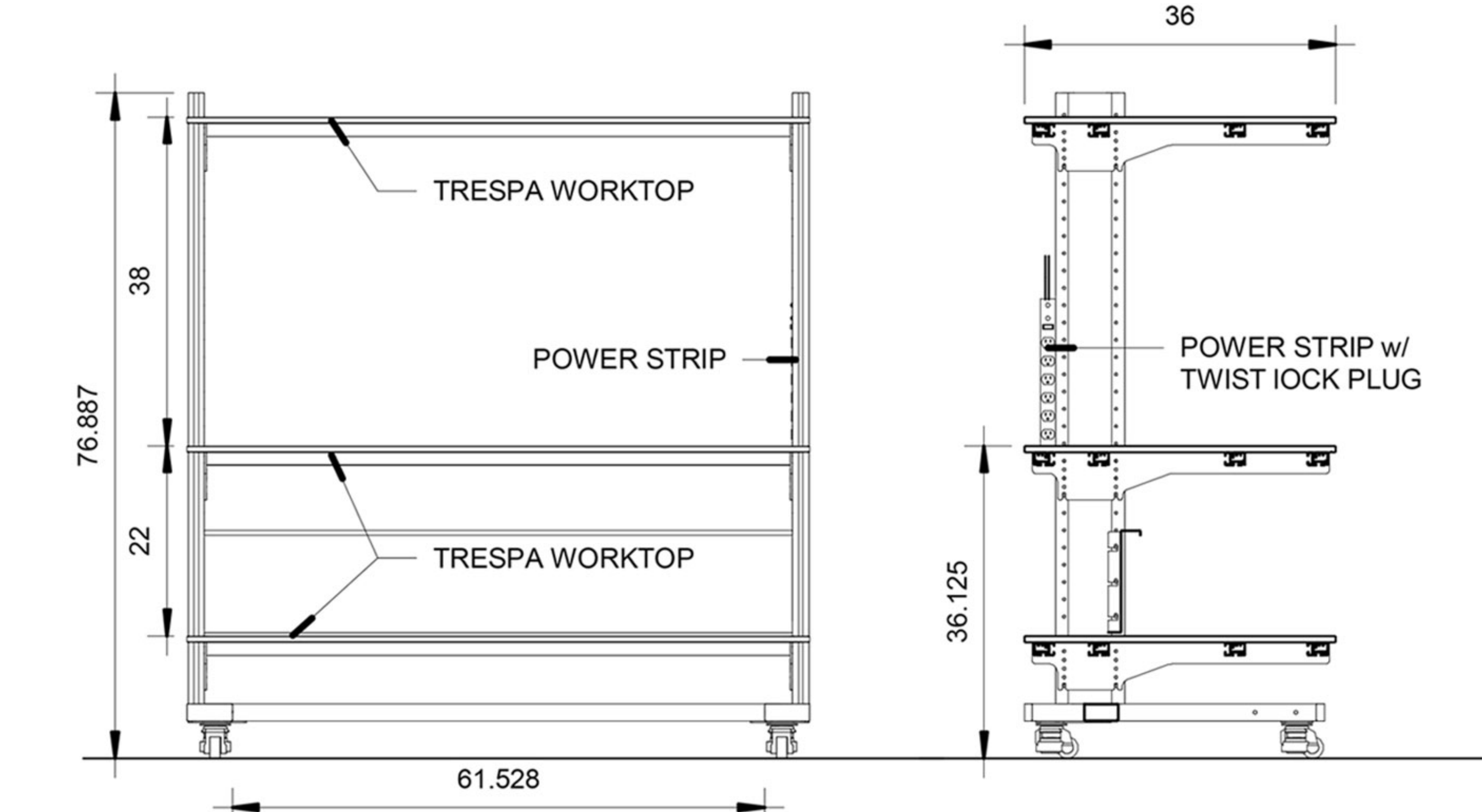

2 BENCH - FRONT VIEW 2.0 1/2" = 1'-0"

3 BENCH - SECTION VIEW 2.0/2.0 1/2" = 1'-0"

Work Bench Features:

- Depth 36"
- Overhead and lower shelving
- Mobile, casters (locking) with levelers
- Power strip with 8 NEMA 5-20R outlets
- Epoxy, black worksurfaces/shelving
- Grey/White Frame
- 2,200 lbs load capacity



[Contact us today for more details](#)

www.bsilab.com